

FFP W81

Joint flank profile

Hard PVC profile with straight edge and 12.5 cm fabric

- Joint flank profile with 30 or 60 mm leg width

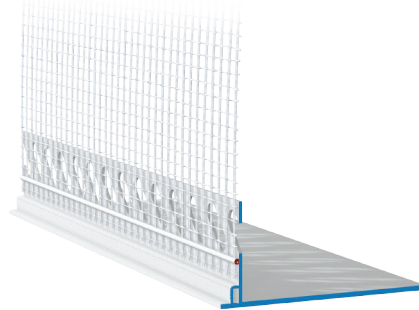

Applications

- for flush connection with plaster on protruding components such as window and door elements and frames in ETIC systems

Properties

- Hard PVC profile manufactured according to DIN 16941
- ultrasonically welded mesh strips
- Approved for external thermal insulation composite systems

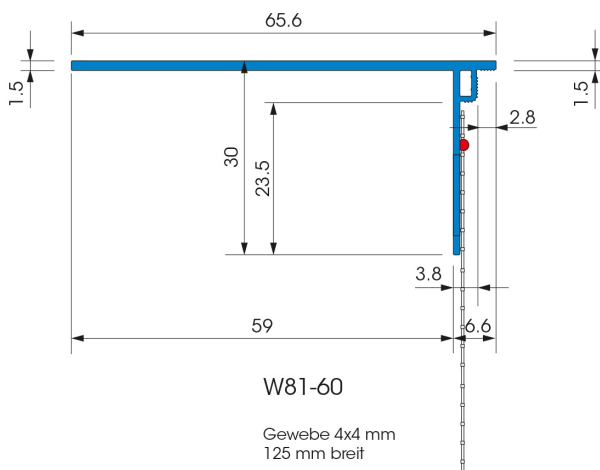

Temperature

- The surface temperature must be at least +5 C° during application and must not exceed +40 C°.

Applying / Processing / Assembling

- The insulation panels are fastened according to the specifications of the respective ETICS-approval/type approval
- The distance between the connecting component and the insulation board/profile must be designed in such a way that the sealing to be installed on site (e.g. PUR sealing tape) can absorb the movements that occur and seal the connection so that it is impermeable to driving rain.
- In order to maintain an even distance between the component and the insulation board, it is advisable to use a spacer (e.g. made of EPS strips).
- Apply reinforcement over the entire surface approx. 15 cm from the edge of the insulation material.
- After the insulation boards have dried sufficiently, glue the joint flank profile to the insulation material using a suitable adhesive and fill the surface flush with the edge using the reinforcing mortar. An additional fixing can be achieved using Z21 plastic nails, for example.
- Prefabricated akurit Z81 corner pieces should be used for the corner formation.
- Connect the profiles with the enclosed plug connectors. The rear leg must be covered with a suitable adhesive tape in the joint area and sealed with it. To do this, remove the spacer in this area.
- Reinforce the surface in accordance with the approval/type approval. Guide the surface fabric up to the pull-off edge of the W81.
- Apply finish coat after a sufficient rest time.

FFP W81

Joint flank profile

Notes

- Profiles with a fabric flag must be filled in as soon as possible after installation on the component and protected from the weather until then.
- Cavities behind the profile must be filled with insulating material.
- To avoid increased heating, dark profiles in particular must be protected from direct sunlight during storage and until plastering.
- Take into consideration the respective system permissions when using the product in thermal insulation composite systems.
- The seal is not included in the scope of delivery.

3D graphic installation

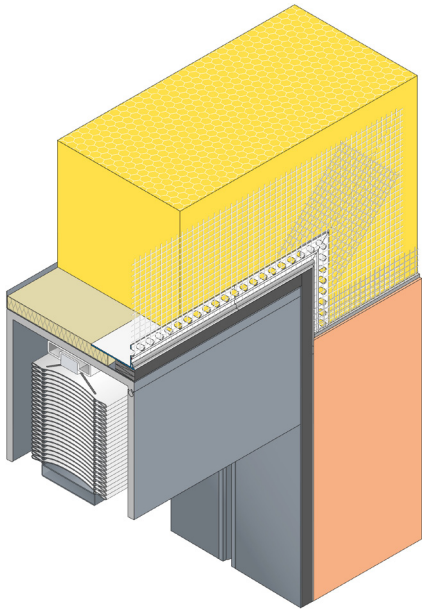

Storage

- Store dry and flat.
- Deformation of the product due to improper storage must be avoided.

Packaging

- 15 pieces/bunch

Technical Data

Length 2.5 m

All data are average values that were determined under laboratory conditions according to relevant test standards and application tests. Deviations are possible under practical conditions.

Product variants

GTIN/EAN 4004637 **Type of execution**

- 86183 2 leg width 30 mm

- 86184 9 leg width 60 mm

General notes

This information sheet provides only general recommendations. Should you have any queries relating to a specific application, please contact our technical sales advisor or call our hotline: +49 541 601-601. All of the details given are based on our current knowledge and experience and on the assumption that the materials are professionally applied and used for their normal purpose. All of the details are non-binding and do not release users from their duty to undertake their own tests to ensure suitability for the intended application. Due to the effects of different weather, processing and construction site conditions, no guarantee can be given for the general validity of all details. We reserve the right to make changes as a result of further development of the product and applications engineering. The general rules for construction engineering, the valid standards and guidelines, and the technical working guidelines must be observed. The publication of this technical data sheet renders all previous editions of this data sheet void. Please obtain the latest information from our website.